

# Cibes B385



The perfect accessibility solution, with an open platform lift for all kind of building environments

## Open platform lift – Key features

- Quick installation, ready to use the same day
  - Robust and reliable screwdriven operation
  - Finishes in grey powder coating in RAL 9006 or stainless steel
  - Does not require a separate machine room
  - Rated load: 385 kg, 3 persons
  - Travel height: < 3 m
  - 60 mm pit or ramp
  - Tactile braille push buttons
  - Emergency light and emergency stop button
  - Low operating costs and low power consumption
  - Tested and approved according to the Machinery Directive 2006/42/EC
- The lift is CE marked



Cibes Lift develop, manufactures and sells a wide range of vertical platform lifts, cabin lifts and stairlifts for public and private environments. Our lifts are designed and manufactured in Sweden but our distribution network is worldwide.

Cibes B385 has been designed to provide a cost-effective solution for easy access in the majority of environments; private, public and commercial.

## The perfect accessibility solution

The Cibes B385 design is based on a screw and nut drive system and has been thoroughly engineered to comply with the highest quality standards. The lift is tested, certified and conforms to the relevant compulsory safety requirements of the European Machinery Directive 2006/42/EC.

## Fast to install and easy to maintain

The lift is easy to install since it does not need a separate machine room or shaft. In addition, the Cibes B385 can be installed in one day with the possibility to be placed directly on the ground. The foundation should be molded and stand the lift load, approximately 800 kg totally. In addition to low installation costs, the platform lift has a low operation and maintenance costs.

## Safety issues

- The control panel consists of easy to use tactile braille push buttons, emergency light, emergency stop button
- A pressure-sensitive plate is located under the platform that will stop any further downward movements if any object should get in the way of the lift when moving down.



| TECHNICAL INFORMATION             | Cibes B385                            |
|-----------------------------------|---------------------------------------|
| Lift location                     | Indoors and outdoors                  |
| Rated load                        | 385 kg/3 pers                         |
| Rated speed (m/sec)               | Max 0.06                              |
| Travel height                     | Up to 3 m                             |
| Pit depth without ramp            | 60 mm                                 |
| Platform dimension (WxD) mm       | 900x1400                              |
| Footprint dimension (WxD) mm      | 1290x1520                             |
| Platform dimension (WxD) mm*      | 1100x1400*                            |
| Footprint dimension (WxD) mm*     | 1490x1520*                            |
| Platform dimension (WxD) mm**     | 1100x1600**                           |
| Footprint dimension (WxD) mm**    | 1490x1720**                           |
| Maximum number of stops           | 2                                     |
| Mast, platform, door frame finish | Powder coated grey, RAL 9006          |
| Landing gate configuration        | Swing door/900x1100 mm                |
| Driving system                    | Screw and nut                         |
| Control system                    | PLC                                   |
| Standard power supply             | 3x400VAC 10A<br>1x230VAC 16A (option) |
| Motor power                       | 1,5 kW                                |
| Control buttons                   | Hold to run                           |
| Floor                             | Aluminium Checker Plate               |
| Machine room                      | Integrated                            |
| In compliance with                | MD 2006/42/EC                         |

\* Adjacent

\*\* Not standard size

For more product details and information about the product and accessory selection, contact Cibes Lift AB.

This product information is general and we reserve the right to modify product design and specifications. No claims shall be construed as warranties or conditions, express or implied, of any product, its fitness for a particular purpose or quality. Minor deviations in color reproduction can occur. © Cibes Lift AB 2014

#### DOOR OPENING ALTERNATIVES

Platform sizes: 900x1400, 1100x1400 Platform sizes: 1100x1400

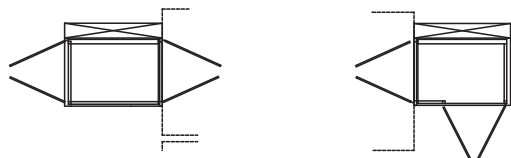

#### PLATFORM SIZES

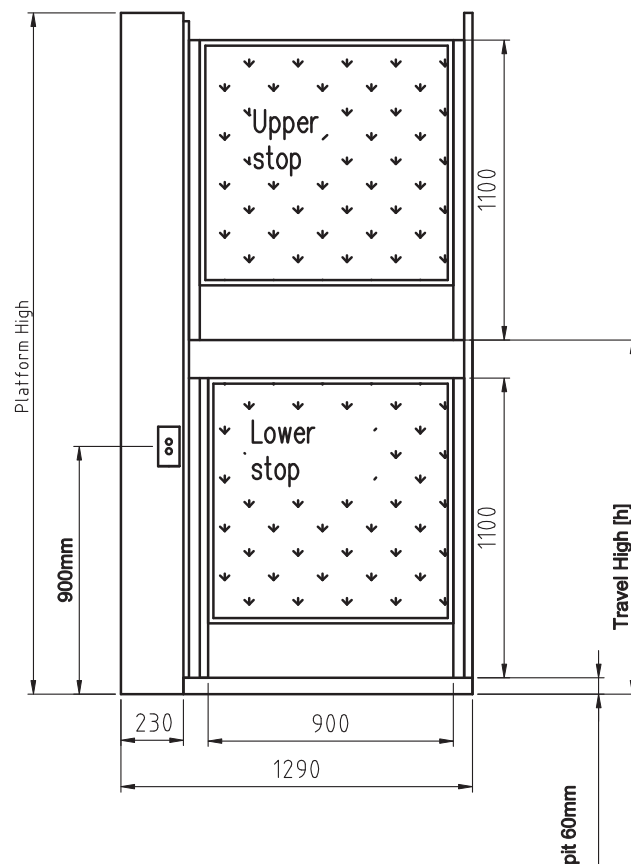
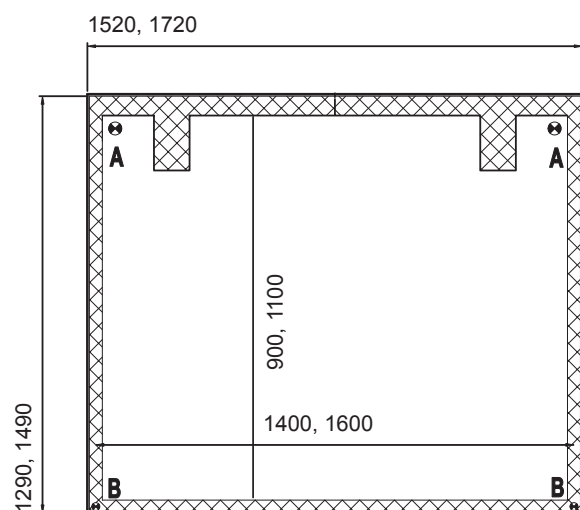

## Accessory and option

Our standard lifts meet the most common requirements and needs that may exist on the market. Your lift can be customized to fit your specific requirements with our wide range of accessories and options.

Our designs are constantly evolving and we are committed to delivering state of the art lift solutions that meet all safety requirements, while also being tailored to fit our customers' every need.

### OPTIONS

#### LOCKING SYSTEMS

School lock system on the platform's control panel

#### EXTRA FUNCTIONS

Remote call button

Remote elbow call button

Additional remote control

Electric emergency lowering

Soft start & stop: 1x230VAC/16A

Possible to connect to external alarm signal

Safety bar on B-side (if close to a wall)

Side Access (90°)

#### FINISH

Safetyglass in a tinted tone

Polycarbonate in brown

Gates and barriers infill in safety glass

Gates and barriers infill in plexi

Gates and barriers infill in polycarbonate

#### DOORS

Powder coated door frame in any RAL color

A thermoisolated full height door for installation directly into a building

### PERFORMANCE

#### STANDARD INDOOR

Cladding of machine room, frames and control panel:  
Powder coated in RAL 9006

Gates and barriers infill plexi

Tactile push buttons rated IP20

Chassis and frame powder coated

#### OUTDOOR

Cladding of machine room, frames and control panel:  
Resistant powder coating for outdoor use, RAL 9006

Gates and barriers infill polycarbonate for external use

Tactile push buttons rated IP65

Chassis and frame galvanized

#### STAINLESS STEEL

Machine room, frames and control panel: Stainless steel

Chassis powder coated, frame in stainless steel

Gates and barriers infill clear safetyglass  
(5+5+0.76 tempered and laminated)

Push buttons rated IP65